



puppy **LOVE STORY**



XK-501

User's Manual

Please read this booklet before playing.
Keep in a safe place after reading.

CASIO

♥ IF YOUR MEMORIES WERE VANISHING...
WHAT WOULD YOU DO?

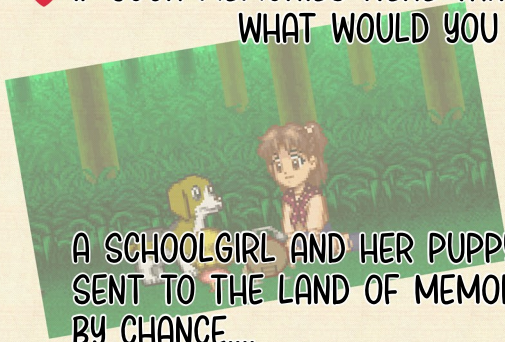

A SCHOOLGIRL AND HER PUPPY,
SENT TO THE LAND OF MEMORIES
BY CHANCE....

WHERE LONG-FORGOTTEN FRIENDS
ARE BEING TORMENTED BY THE
VEGGIE CORPS!



CAN YOU SAVE YOUR CHERISHED
MEMORIES, AND DEFEAT
THE VEGGIE CORPS?



Contents

Instructions for Parents.....	2
Before You Play.....	4
Seals You Can Make.....	6
Introducing the Cast of Characters.....	8
Controller Guide.....	11
Starting / Ending Play.....	12
Starting.....	12
Ending.....	14
Don't Let the Veggie Corps Win!	15
Let's Make a Seal!.....	16
Let's Stick That Seal!.....	17
After-Sales	18
CASIO Service Centers.....	19

INSTRUCTIONS FOR PARENTS

Safety Warnings

- ▶ It has been reported that in rare cases, bright lights or brightly flashing lights can cause temporary muscle spasms, or loss of consciousness, in some people. If you think you might be subject to any of these conditions, please consult your physician before use. Additionally, if you experience any of these conditions while using the software, stop playing immediately and get examined by a physician.
- ▶ When playing for extended periods of time, it is cautioned to take 10-15 minute breaks every hour.
- ▶ It is cautioned to avoid play while tired or deprived of sleep.
- ▶ While playing, it is cautioned to position yourself as far away from the TV as possible.

Usage Warnings

- ▶ After use, please be sure to remove the Loopy SV-100's AC adapter from the outlet.
- ▶ Avoid using or storing the cartridge under extreme temperatures, and please protect it from shock. Do not disassemble under any circumstances.
- ▶ Please don't touch the cartridge connector, or expose it to water or dirt. Doing so may cause malfunction.

- ▶ Do not introduce chemical solvents such as alcohol, acetone, or thinners when cleaning.
- ▶ Please ensure the Loopy SV-100 power is off when inserting or removing the cartridge.

Connecting to a TV

- ▶ Connecting to a TV should always be performed by a parent or guardian. If done by a child or someone unfamiliar with the equipment, there is a risk of electrical shock or other serious accidents.

Inserting Cartridges

- ▶ Take care to insert and remove the Game and Seal cartridges properly. Improper insertion or removal can cause malfunctions.

Especially when used by small children, please ask a parent or guardian's help.

Please consult the Loopy SV-100 manual for detailed information regarding connections.

Memory Backup Feature

- ▶ This game cartridge is equipped with a memory backup feature which records your progress during play. However, please be aware that data may be erased by suddenly switching off power, improperly inserting or removing the cartridge, or even service of the cartridge.

In the text of this manual you will find headings marked: "To Parents & Guardians." Please share this information with children who will be playing the game.

BEFORE YOU PLAY

Please follow these rules!

- ◆ Take a short break of 10-15 minutes for every hour of play.

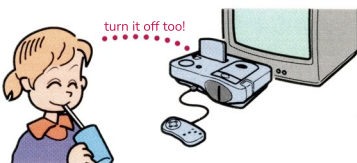

- ♣ Sit as far away from the TV screen as you can.

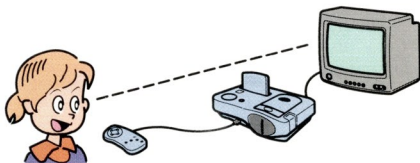

- ♠ Please don't play if you're feeling tired or sleepy.

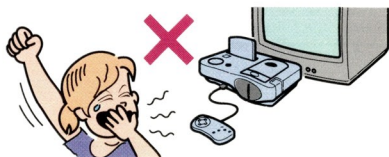

- ♥ If you start to feel weird while playing, stop playing and tell an adult.

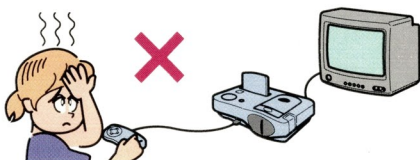

Ask an adult!

? Is your Loopy properly hooked up to the TV?

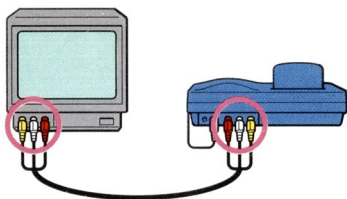

? Is "Puppy Love Story" inserted securely?



To Parents & Guardians

Connecting to a TV should always be performed by a parent or guardian. If done by a child or someone unfamiliar with the equipment, there is a risk of electrical shock or other serious accidents.

Insertion and removal of game and seal cartridges should also be performed by an adult. Improper insertion or removal can cause malfunctions. Especially when used by small children, please ask a parent or guardian's help.

Please consult the Loopy SV-100 manual for detailed information regarding connections.

SEALS YOU CAN MAKE

MEMORY SEALS



- ※ Among the seals from the Land of Memories, there are 25 seals that come with a story attached. Collect all of these and you can make your very own “Puppy Love Story” picture book!

PUPPY SEALS

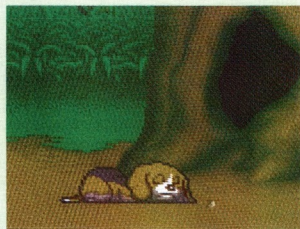

※ Your puppy can do so many different poses.

Make a seal out of your favorite!

**But... you have to complete the game first!
Then the real fun can begin.....**

INTRODUCING THE CAST OF CHARACTERS



MOMO

(You can change
my name!)

That's me! Just a normal (I think...) girl who goes to elementary school. For my birthday, Papa got me a puppy. I was so, so happy! One day, we went on a journey together...



BARKLEY

(You can change
my name!)

The puppy I got on my birthday. Isn't he cute?! He's a very clever boy, as well. He saved the day in the Land of Memories, and kept me safe.



PAPA



MAMA

THE LAND OF MEMORIES

The people I met in the Land of Memories...

LONG-LOST FRIENDS

My precious memories... I missed them all so much!



Grandpa

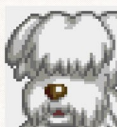

Captain



Momo-01

(My name will change!)



Judy



Gunbot

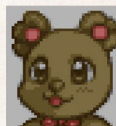

Barry

NEW FRIENDS



Mr. Clock

THE VEGGIE CORPS

I don't even want to look at them any more!
...is what I'd like to say, but we have to find a way to
get along... somehow...



The Dark Lord
Cabbage



Cucumbros



Potato
Bombombs



Hallo-Pumpkin

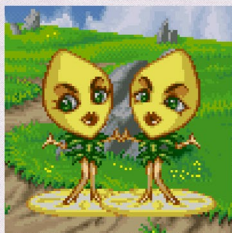



Miracle Lemons



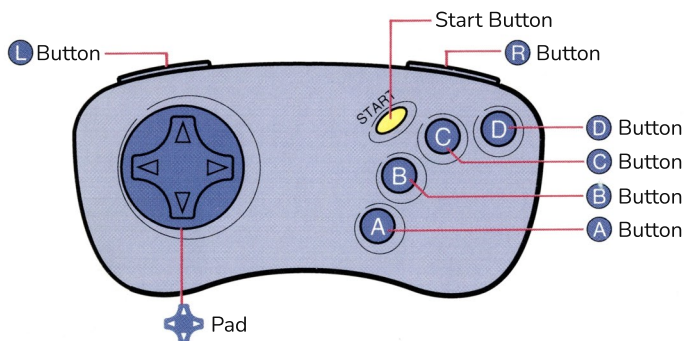

The Big Cabbage

CONTROLLER GUIDE



 Pad Press to move directions, choose options

 Button... Press to continue, or confirm a selection

 Button... Press to cancel, return, or delete

 Button

 Button } ...Not used by "Puppy Love Story"

 Button... Press on the title screen to start the game

When you see the ▼, press the  button!



Welcome to the world of
"Puppy Love Story!" ▼

 button to continue
to the next screen

STARTING/ENDING PLAY

STARTING

- 1 Switch on the Loopy SV-100.



- 2  Press Start!!



Oh, I remember! When you see this mark, hit the...  button!

- 3 Choose from the options.



You can find some basic instruction here.

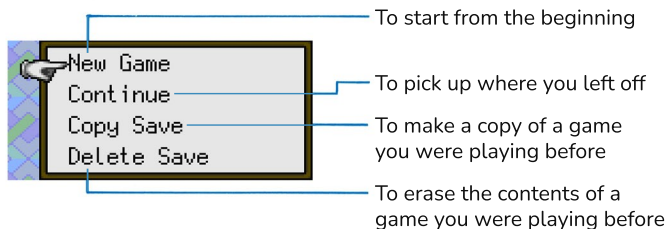

Remember, press the **A** button to make a choice!

To cancel, use the **B** button!



Choose a “me & my puppy journal!”

You can use up to three at once.

After choosing “New Game”

Now to pick a name for the main character! It can be up to 8 letters long.

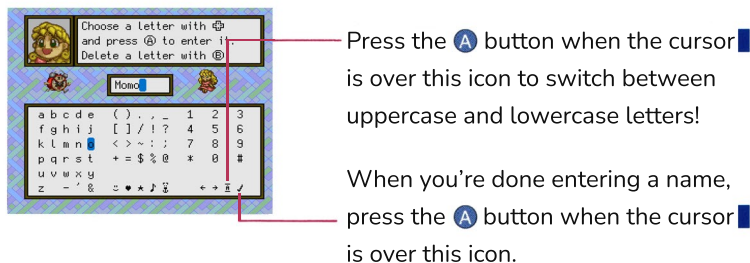

Remember this! When it’s time to pick a name for your puppy, you’ll use the same method. Your puppy’s name can also have up to 8 letters!

**YOU’RE READY...
LET THE ADVENTURE BEGIN!**



Switch off the Loopy SV-100.

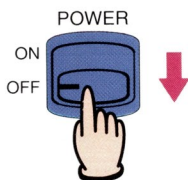

Next time you play, if you choose the same save, you should be able to continue where you left off, or a little bit before it.

DON'T LET THE VEGGIE CORPS WIN!

Along your travels, the Veggie Corps will try to jam you up any way they can, with puzzles, mazes, and games!



You'll learn how to play a bunch of different games during your adventure. The first time you play, be sure and choose "Yes, explain!"



LET'S MAKE A SEAL!

Verify before making a seal...



Is the Seal Cartridge properly installed in your Loopy SV-100?



Is the Seal Cartridge Cover of your Loopy SV-100 securely closed?

While your Loopy is working...

- ▶ Don't remove the Seal Cartridge cover!
- ▶ Don't pull on the seal paper!
- ▶ Don't depress the cut button before the print finishes!

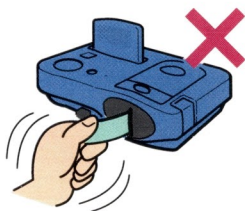

When the seal stops moving, and you don't hear printing sounds any more, press the cut button!

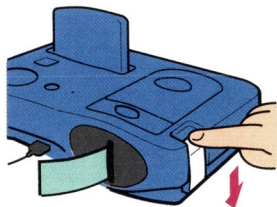

LET'S STICK THAT SEAL!

Seals won't stick to...

- Rough surfaces
- Dirty, oily, or wet places

Please don't stick your seals...

- On your body or other people
- On food or drinks
- On cups, utensils, or anything you put in your mouth
- Places that will get lots of direct sunlight
- Places that might get hit by rain or water
- Anywhere that might harm or annoy other people

- 1 Peel off the backing, and stick it!

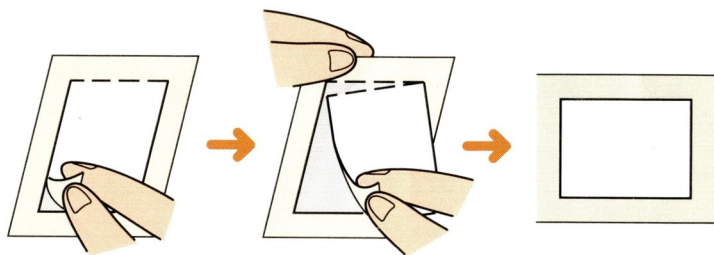

If you remove a seal after sticking it, some adhesive may remain behind.

AFTER-SALES

● To request repairs

Please inquire with the seller or a Casio Service Center for service.

If the product can be repaired, repairs will be made by request, for a fee.

● Please understand the following before service

Items you send in for repair may be replaced partially or completely.

Your saved data cannot be guaranteed.

● If you're not sure how to proceed

Please contact the seller, or a Casio Service Center listed in this manual.

CASIO SERVICE CENTERS

■ For after-sales, please contact the seller, or the Casio Service Center nearest you from the following list.

Hokkaido
札幌 〒003 札幌市白石区菊水五条1-19-5
☎011-842-1231

Northeast
青森 〒030 青森市橋本2-13-4
☎0177-74-1920
仙台 〒980 仙台市宮城野区榴岡5-1-35
☎022-256-8822
山形 〒990 山形市諏訪町1-1-1
☎0236-23-4179

Kanto
宇都宮 〒320 宇都宮市西大寛2-1-3
☎0286-34-0398
水戸 〒310 水戸市城南3-10-17
☎0292-25-6985
高崎 〒370 高崎市新町6-7-1
☎0273-23-1511
埼玉 〒331 大宮市大成町4-8-3
☎048-666-8567
千葉 〒260 千葉市中央区神明町13-4
☎043-243-1755
東京 〒101 千代田区外神田2-2-18
(修理) ☎03-5294-7011
(操作説明) ☎03-5294-7015

秋葉原 〒101 千代田区神田佐久間町2-15
☎03-5820-9871
多摩 〒190 立川市曙町1-2-2-17
☎0425-23-3990
横浜 〒231 横浜市中区南仲通3-26
☎045-211-0821

Shinetsu
長野 〒380 長野市大字稲葉字日詰1592-1
☎0262-22-3322
新潟 〒950 新潟市弁天橋通り3-9-12
☎025-287-1151

Hokuriku
金沢 〒920 金沢市南新保町1-5-2
☎0762-24-0061

Tokai
静岡 〒422 静岡市津島町16-2-3
☎054-281-8085
名古屋 〒460 名古屋市中区栄4-6-15
☎052-263-0454

Kinki
京都 〒600 京都市下京区五条通り堀川東入ル
☎075-351-1161
大阪 〒530 大阪市北区天神橋6-3-16
☎06-352-7111
神戸 〒650 神戸市中央区伊藤町119
☎078-392-2145

Chugoku
岡山 〒700 岡山市西古松西町9-1
☎086-241-8471
広島 〒733 広島市西区大芝2-14-10
☎082-230-5900

Shikoku
高松 〒760 高松市今里町2-2-1
☎0878-62-5240

Kyushu
福岡 〒812 福岡市博多区東比恵2-16-23
☎092-411-2939
熊本 〒862 熊本市健軍1-38-7
☎096-367-0614
鹿児島 〒890 鹿児島市郡元1-1-3
☎0992-56-3573

※ Please be aware that telephone numbers and addresses may be subject to change

MEMO

CASIO